

# MERIDIAN VALLEY PLAZA

13201-13304 SE 240TH STREET | KENT, WA 98042

Perform Properties

## Property Details

### Owned GLA

51,597 SF

### Availability

2 Suites | 1,761 SF

## Overview

- Anchored by a QFC supermarket, providing a steady stream of customers and enhancing the center's appeal.
- Located with easy access to major highways and public transit, ensuring convenience for both customers and employees.
- Situated in a densely populated area with a high average household income, ensuring a robust customer base for businesses.

## Tenant Mix



# MERIDIAN VALLEY PLAZA

13201-13304 SE 240TH STREET | KENT, WA 98042

Perform Properties

## Demographics

Source: Advan, 2025.

	Population	Daytime Population	Households	Avg. HH Income	Med. HH Income
1-MILE RADIUS	12,505	6,926	4,026	\$172,319	\$145,507
3-MILE RADIUS	106,571	76,911	35,428	\$141,815	\$120,946
5-MILE RADIUS	224,330	229,985	78,173	\$146,385	\$123,066

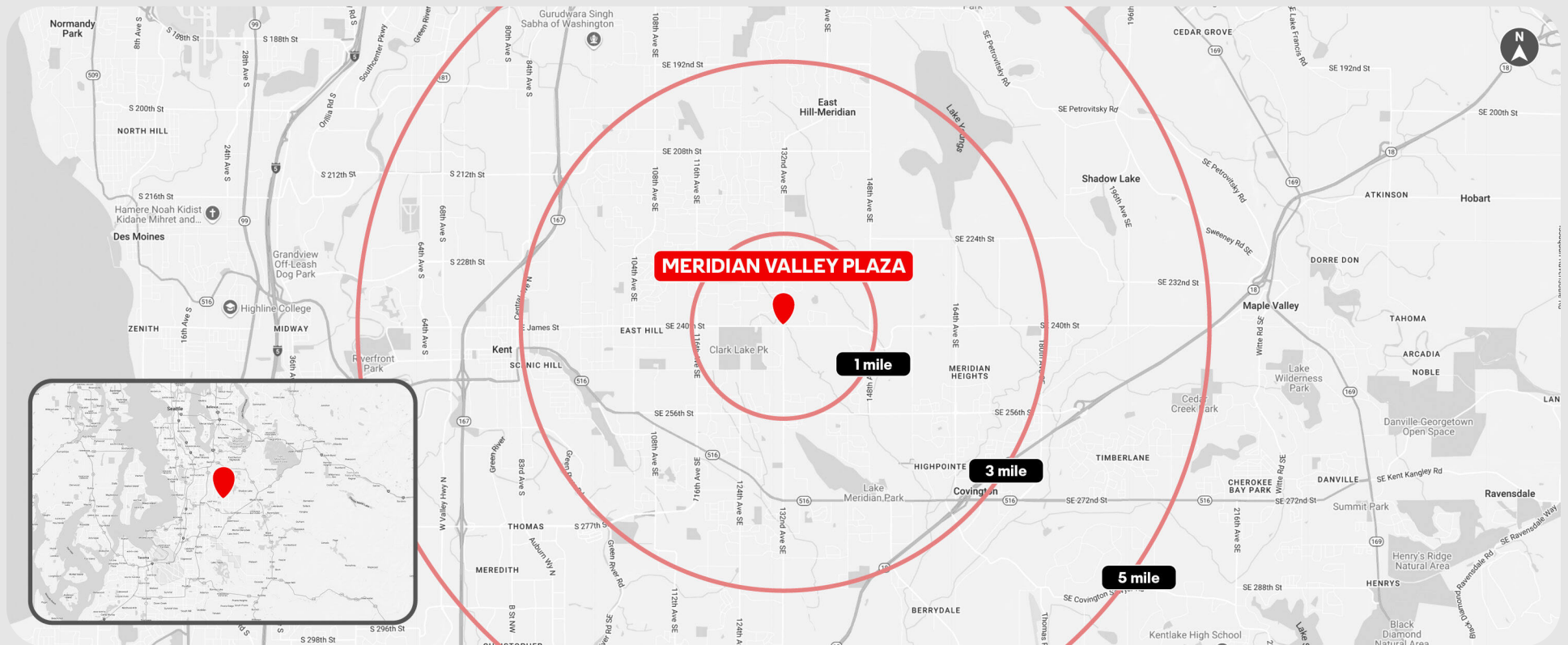

# MERIDIAN VALLEY PLAZA

13201-13304 SE 240TH STREET | KENT, WA 98042

Perform Properties

## Market Aerial

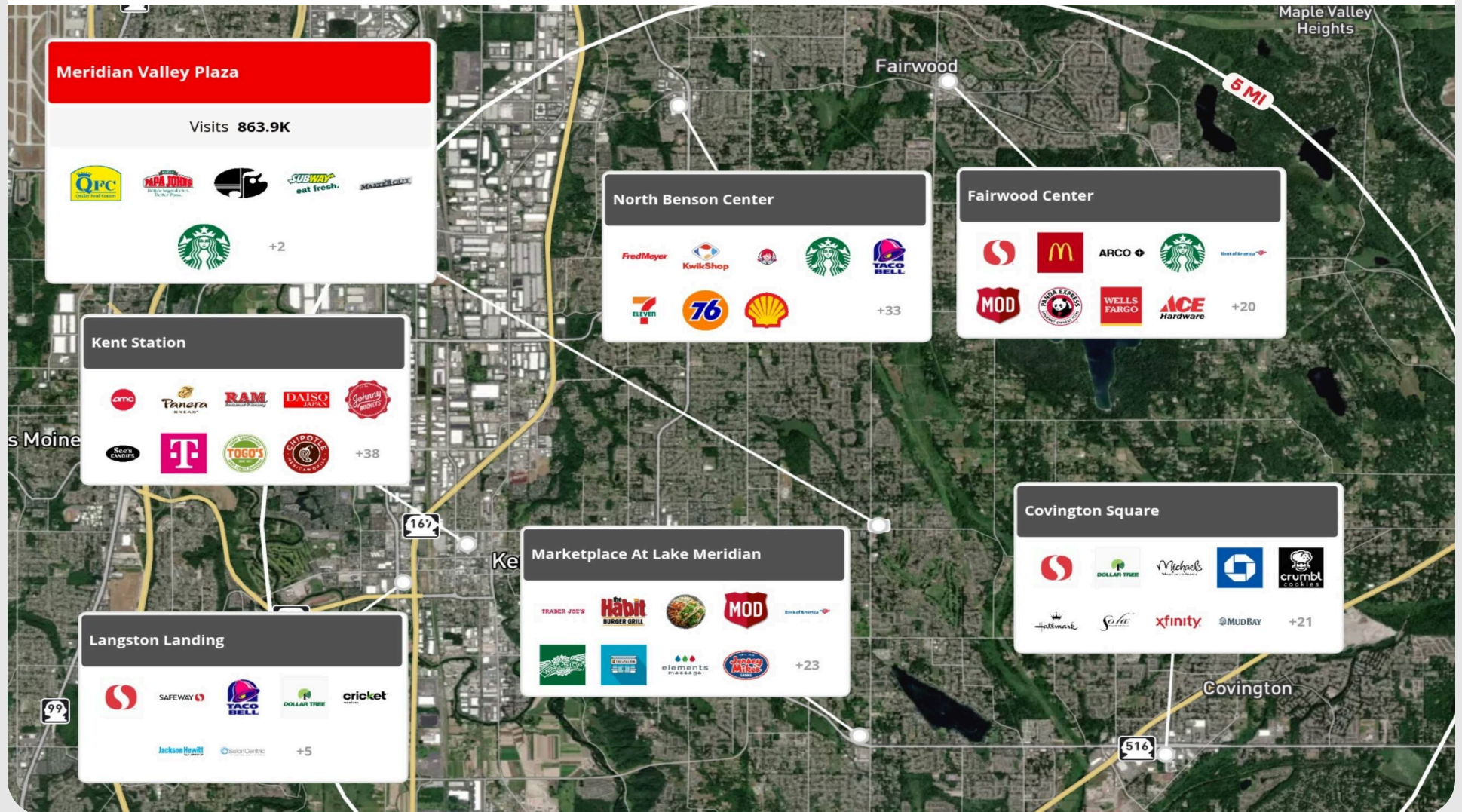

# MERIDIAN VALLEY PLAZA

13201-13304 SE 240TH STREET | KENT, WA 98042

Perform Properties

## Site Plan

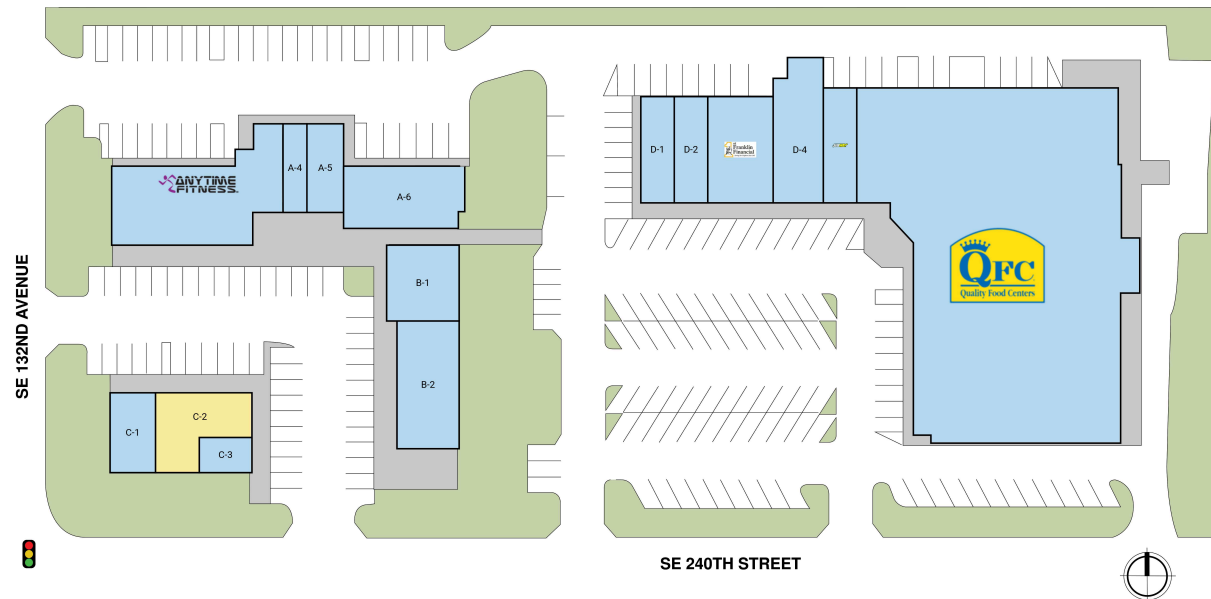

Suite	Tenant	GLA (SF)
C-2	AVAILABLE	1,692
ATM	AVAILABLE	69
E	QFC	27,406
A-1	ANYTIME FITNESS	5,062
B-2	CREEKSIDE FAMILY DENTISTRY	2,555
D-4	Music & Arts	2,185
B-1	MERIDIAN VALLEY DENTAL CENTER	1,727
D-3	1ST FRANKLIN FINANCIAL	1,671
A-6	KIMS TAEKWONDO	1,620
A-5	MERIDIAN COUNSELING SERVICES	1,487
D-2	TACOSLAND	1,318
D-1	HAIRMASTERS	1,244
D-5	SUBWAY	1,167
C-1	NOVA VENTURES	990
C-3	GINA NAILS	900
A-4	CUSTOMIZED MASSAGE	504

# MERIDIAN VALLEY PLAZA

13201-13304 SE 240TH STREET | KENT, WA 98042

Perform Properties

## Get in Touch with Us

### Leasing

David Marks  
**206-785-3723**  
[DMarks@performproperties.com](mailto:DMarks@performproperties.com)

### Pop-up & Short-term Leasing

Specialty Leasing Team  
**206-401-7768**  
[specialtyleasing@performproperties.com](mailto:specialtyleasing@performproperties.com)

### Property Management

Eric Nickelson  
**858-255-4922**  
[ENickelson@performproperties.com](mailto:ENickelson@performproperties.com)



*This document is for general information purposes only. Any and all features, matters and other information depicted hereon or contained herein are for illustrative marketing purposes only, are subject to modification without notice, are not intended to be relied upon by any party and are not intended to constitute representations or warranties as to any matter, including ownership of the real property depicted hereon or any part thereof, the size and nature of improvements (or that any improvements will be constructed or will continue to exist as depicted), or the identity or nature of any occupants thereof.*

Learn more about Meridian Valley Plaza at [performproperties.com/property/meridian-valley-plaza](https://performproperties.com/property/meridian-valley-plaza)

