

# POLO GROUNDS MALL

926 S. MILITARY TRAIL | WEST PALM BEACH, FL 33415

Perform Properties

## Property Details

### Owned GLA

130,766 SF

### Availability

2 Suites | 3,984 SF

## Overview

- Anchored by Publix with several national and regional tenant brands
- Combined traffic counts of 55,000+ VPD
- Palm Beach International Airport (PBI) is located 4 miles northeast & serves 6.7+ million passengers annually
- Located adjacent to Trump International Golf Course

## Tenant Mix



# POLO GROUNDS MALL

926 S. MILITARY TRAIL | WEST PALM BEACH, FL 33415

Perform Properties

## Demographics

Source: Advan, 2025.

	Population	Daytime Population	Households	Avg. HH Income	Med. HH Income
1-MILE RADIUS	21,606	16,185	7,165	\$83,625	\$72,861
3-MILE RADIUS	147,457	115,573	50,675	\$92,990	\$78,230
5-MILE RADIUS	359,399	362,747	137,218	\$104,644	\$80,561

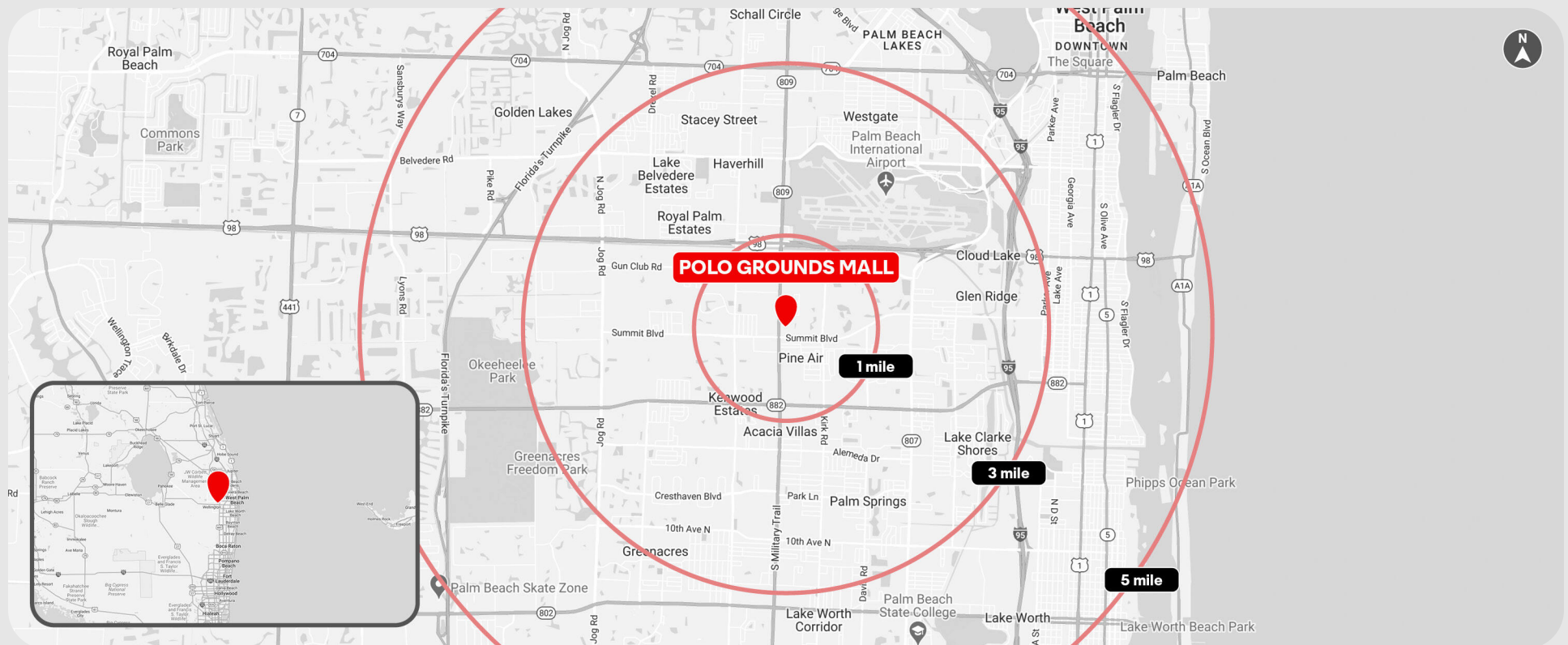

# POLO GROUNDS MALL

926 S. MILITARY TRAIL | WEST PALM BEACH, FL 33415

Perform Properties

## Market Aerial

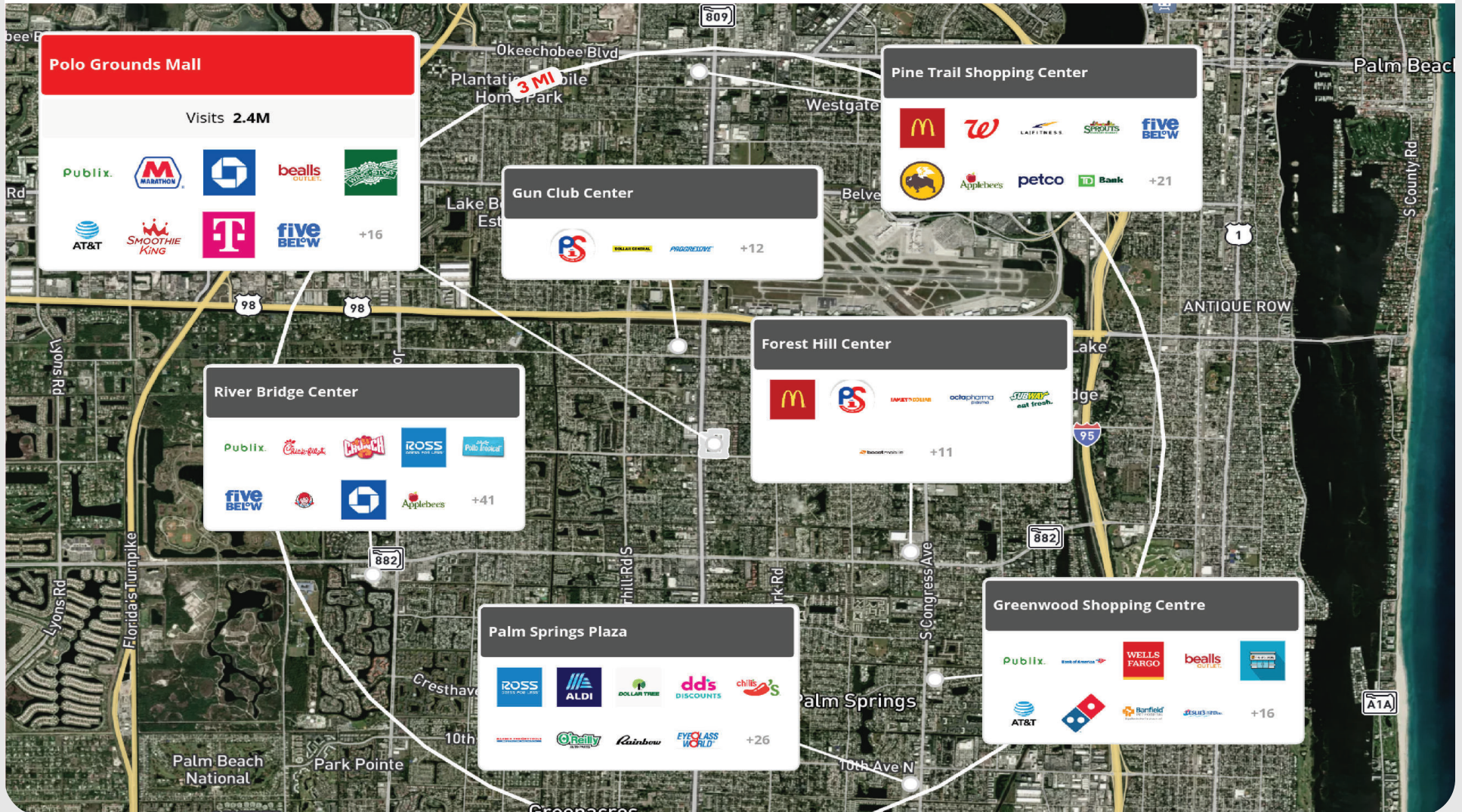

# POLO GROUNDS MALL

926 S. MILITARY TRAIL | WEST PALM BEACH, FL 33415

Perform Properties

## Site Plan

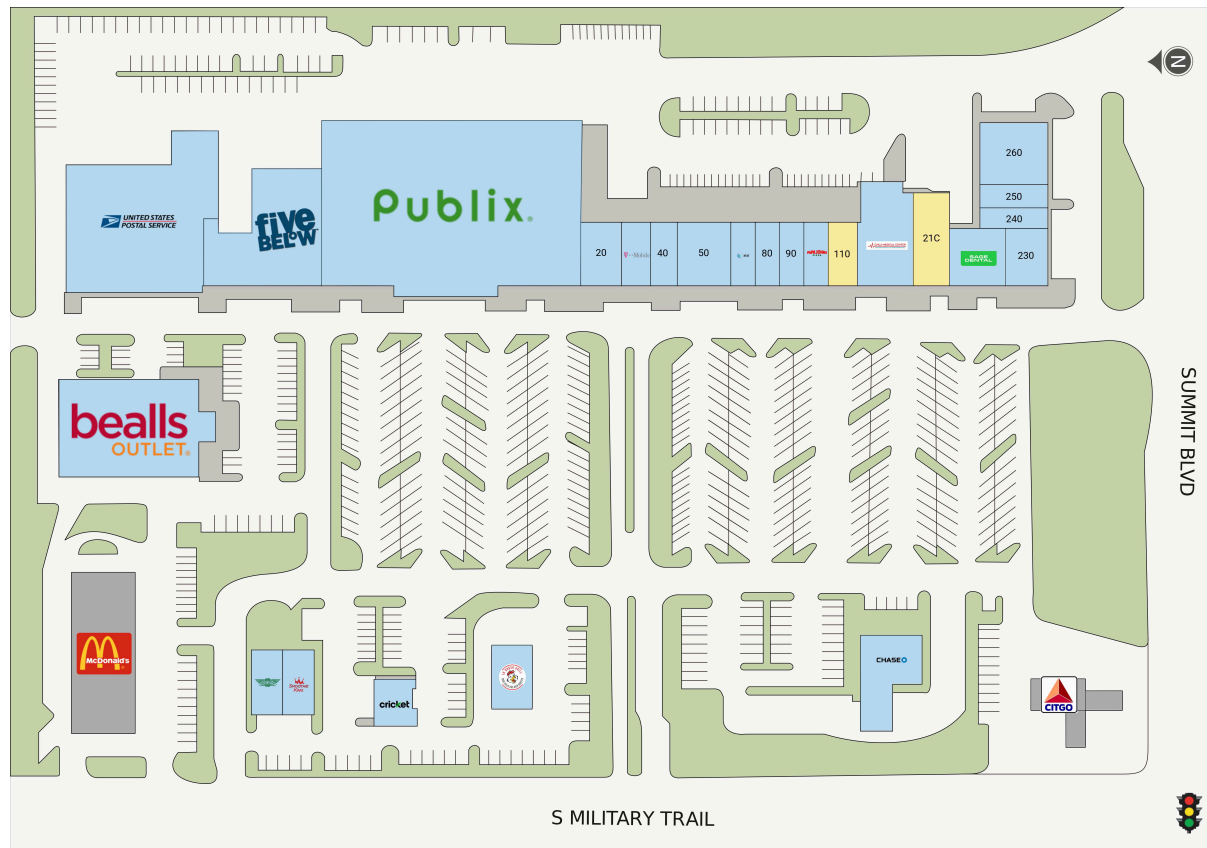

Suite	Tenant	GLA (SF)
21C	AVAILABLE	2,444
110	AVAILABLE	1,540
10	PUBLIX SUPER MARKET	45,600
180	UNITED STATES POSTAL SERVICE	20,156
F00	BEALL'S	13,750
160	FIVE BELOW	8,930
200	CMLA MEDICAL CENTER	5,216
260	POLO GROUNDS LAUNDRY	4,000
50	STAR LIQUORS	3,500
22A	Sage Dental	2,595
C00	La Brasa	2,261
B00	CHASE BANK	2,250
230	Golden Krust	2,065
20	DIVA NAILS	1,803
E10	WINGSTOP	1,504
E20	SMOOTHIE KING	1,472
100	PAPA JOHN'S PIZZA	1,400
90	China Queen	1,400
80	Mercedes Jewelry	1,400
70	AT&T	1,400
40	DEL TORO INSURANCE	1,400
30	T-MOBILE	1,400
D00	CRICKET WIRELESS	1,280
250	XENIA SALON	1,000
240	BILL'S BARBERSHOP	1,000

# POLO GROUNDS MALL

926 S. MILITARY TRAIL | WEST PALM BEACH, FL 33415

Perform Properties

## Get in Touch with Us

### Leasing

Sarah Jordan  
**561-462-8486**  
[sjordan@performproperties.com](mailto:sjordan@performproperties.com)

### Pop-up & Short-term Leasing

Specialty Leasing Team  
**561-823-6129**  
[specialtyleasing@performproperties.com](mailto:specialtyleasing@performproperties.com)

### Property Management

Lataraini Carter-Busch  
**215-330-4206**  
[lcbusch@performproperties.com](mailto:lcbusch@performproperties.com)



*This document is for general information purposes only. Any and all features, matters and other information depicted hereon or contained herein are for illustrative marketing purposes only, are subject to modification without notice, are not intended to be relied upon by any party and are not intended to constitute representations or warranties as to any matter, including ownership of the real property depicted hereon or any part thereof, the size and nature of improvements (or that any improvements will be constructed or will continue to exist as depicted), or the identity or nature of any occupants thereof.*

Learn more about Polo Grounds Mall at [performproperties.com/property/polo-grounds-mall](https://performproperties.com/property/polo-grounds-mall)

