

HANOVER CENTER

3501 OLEANDER DRIVE | WILMINGTON, NC 28403

Perform Properties

Property Details

Owned GLA Availability

331,813 SF

7 Suites | 37,394 SF

Overview

- Anchored by Harris Teeter and Hobby Lobby, this center benefits from excellent visibility and access along the heavily traveled Oleander Drive corridor
- Centrally located in Wilmington adjacent to Independence Mall - 4 miles to Downtown Wilmington, 7 miles to Wrightsville Beach, and 2 miles from University of North Carolina at Wilmington (17,000+ students)
- 1.2 miles from New Hanover Regional Medical Center (7,000 employees)
- At the epicenter of retail adjacent to the newly redeveloped Independence Mall

Tenant Mix



HANOVER CENTER

3501 OLEANDER DRIVE | WILMINGTON, NC 28403

Perform Properties

Demographics

	Population	Daytime Population	Households	Avg. HH Income	Med. HH Income
1 MILE	8,621	14,664	4,395	\$89,641	\$65,753
3 MILES	79,268	128,926	35,931	\$74,782	\$56,513
5 MILES	135,021	185,336	59,463	\$82,186	\$62,523

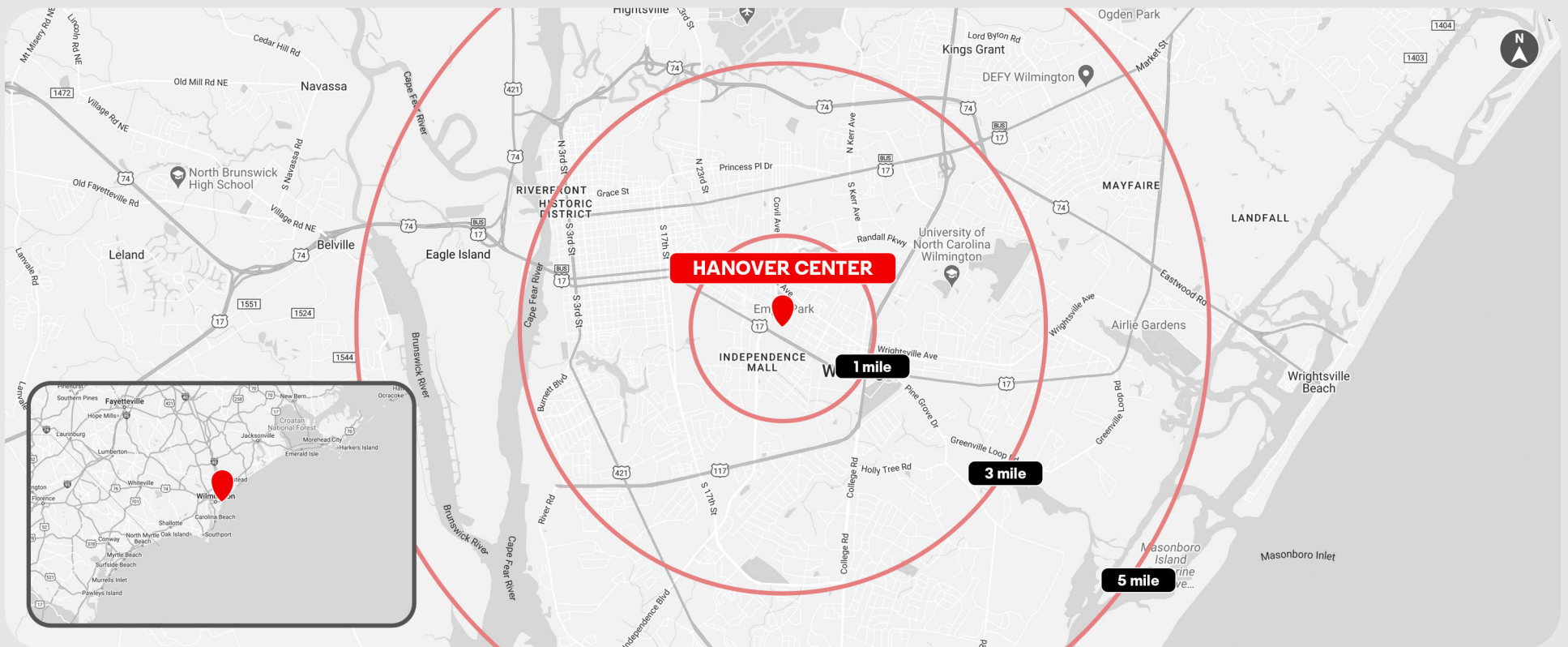

HANOVER CENTER

3501 OLEANDER DRIVE | WILMINGTON, NC 28403

Perform Properties

Market Aerial

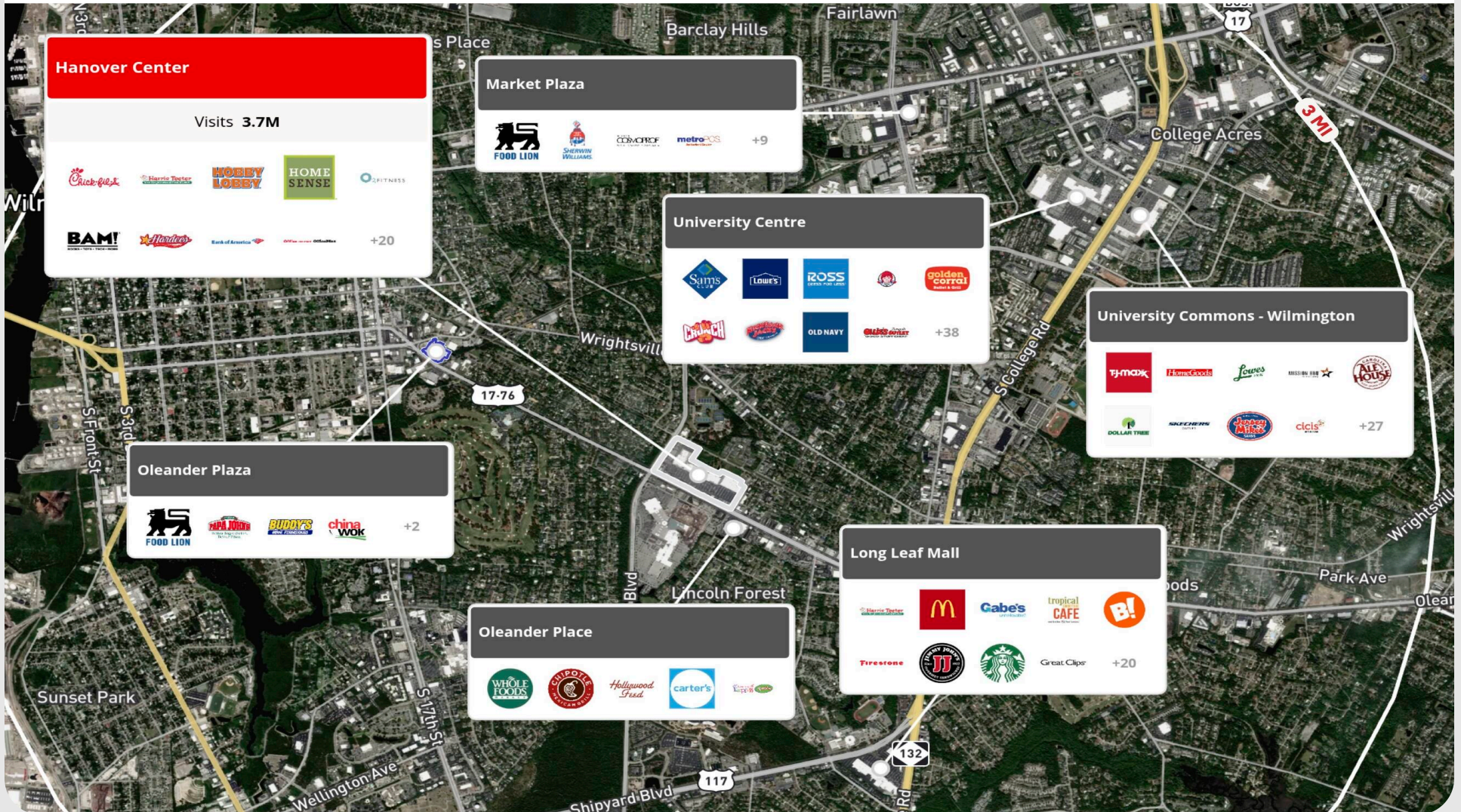

HANOVER CENTER

3501 OLEANDER DRIVE | WILMINGTON, NC 28403

Perform Properties

Site Plan

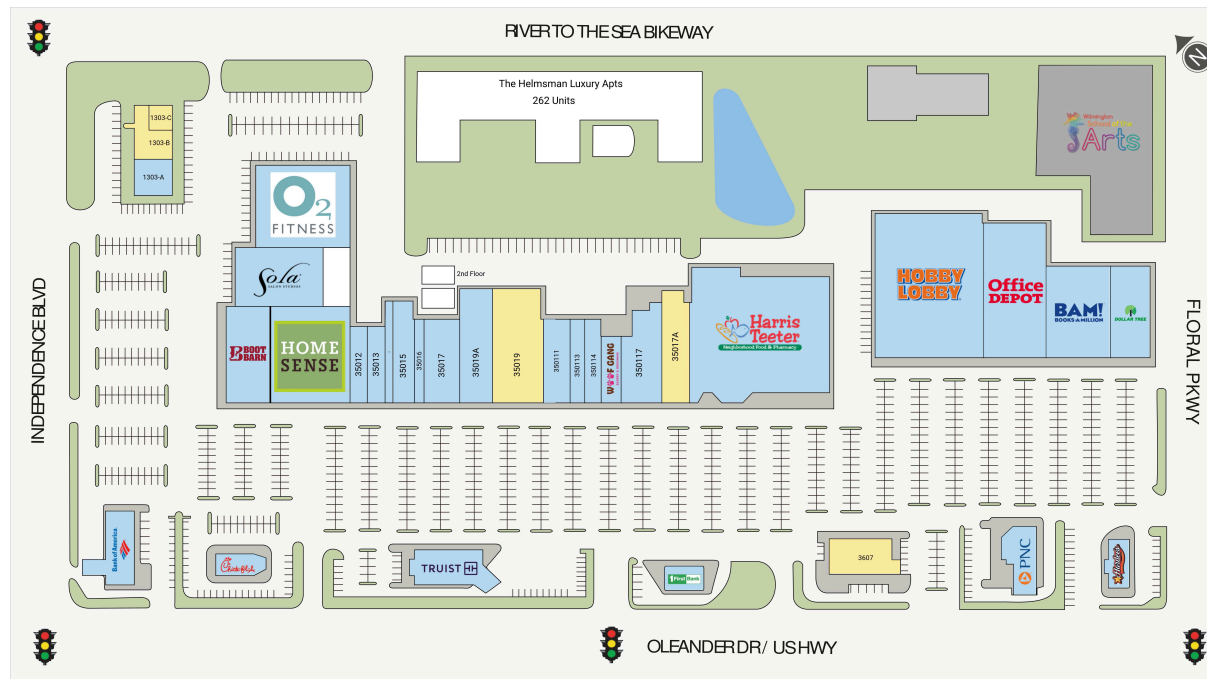

Suite	Tenant	GLA (SF)
35019	AVAILABLE	13,920
35017A	AVAILABLE	6,693
3607	AVAILABLE	6,600
1303-B	AVAILABLE	6,009
35014C	AVAILABLE	3,000
1303-C	AVAILABLE	960
35014D	AVAILABLE	212
350118	HARRIS TEETER	50,750
3715	HOBBY LOBBY	46,080
1315	O2 Fitness	26,000
35011	HOMESENSE	25,000
3727	OFFICE DEPOT	24,053
3737	BOOKS A MILLION	15,120
35011A	BOOT BARN	14,160
3741	DOLLAR TREE	11,002
35019A	GREAT OUTDOOR	10,600
350111	NICHE DECOR	8,230
3305	BANK OF AMERICA	5,970
3417	TRUIST	5,798
1329	SOLA SALON	5,640
350117	SAS SHOES	5,400
3389	CHICK-FIL-A	3,936
3709	PNC BANK	3,645
35013	WILMINGTON BLINDS & MORE	3,600
35017	MY EYE DR	3,500
1303-A	TRUSS VET	3,248
350114	J. MICHAEL'S PHILLY	3,000
1420	HARDEE'S	2,803
350113	QDOBA MEXICAN EATS	2,500
3605	FIRST BANK	2,230
35012	DRIFT COFFEE AND KITCHEN	2,200
35015	GRAND NAILS	2,008
35016	Wild Bird Center	2,000
35014B	STRETCH ZONE	1,890
35014A	HOTWORX	1,890
350116	WOOF GANG BAKERY & GROOMING	1,500

HANOVER CENTER

3501 OLEANDER DRIVE | WILMINGTON, NC 28403

Perform Properties

Get in Touch with Us

Leasing

Catie Whorton

910-469-1170

cwhorton@performproperties.com

Pop-up & Short-term Leasing

Specialty Leasing Team

910-886-2363

specialtyleasing@performproperties.com

Property Management

Scott Krumm

609-678-5011

skrumm@performproperties.com



This document is for general information purposes only. Any and all features, matters and other information depicted hereon or contained herein are for illustrative marketing purposes only, are subject to modification without notice, are not intended to be relied upon by any party and are not intended to constitute representations or warranties as to any matter, including ownership of the real property depicted hereon or any part thereof, the size and nature of improvements (or that any improvements will be constructed or will continue to exist as depicted), or the identity or nature of any occupants thereof.

Learn more about Hanover Center at performproperties.com/property/hanover-center

