

THE SHOPS AT SKYVIEW

40-24 COLLEGE POINT BLVD | FLUSHING, NY 11354



Property Details

Owned GLA

559,978 SF

Availability

8 Suites | 109,205 SF

Parking Spaces

2,577

Overview

- Dominant multi-level urban retail shopping center located in the heart of Flushing, Queens, NY, one of the most densely populated neighborhoods in the country
- Mixed-use development includes 1,200 apartments and 50,000 SF of medical office with a daytime population of 615,000 within 3-miles
- Well-located at the intersection of Roosevelt Avenue and College Point Blvd, adjacent to the Van Wyck Expressway with traffic counts over 300,000 VPD

Tenant Mix

skyFOODS

Nike ClearanceStore

Marshalls

Burlington

OLD NAVY

UNIQLO



THE SHOPS AT SKYVIEW

40-24 COLLEGE POINT BLVD | FLUSHING, NY 11354



Demographics

Source: CreditIntell, 2024. View more demographics [here](#)

	Population	Daytime Population	Households	Avg. HH Income	Med. HH Income
1 MILE	92,564	84,439	32,858	\$68,661	\$50,791
3 MILES	769,763	652,226	266,688	\$96,368	\$75,290
5 MILES	1,672,219	1,441,493	590,780	\$100,157	\$79,752



THE SHOPS AT SKYVIEW

40-24 COLLEGE POINT BLVD | FLUSHING, NY 11354



Competition Aerial



THE SHOPS AT SKYVIEW

40-24 COLLEGE POINT BLVD | FLUSHING, NY 11354



East Building - Level 2

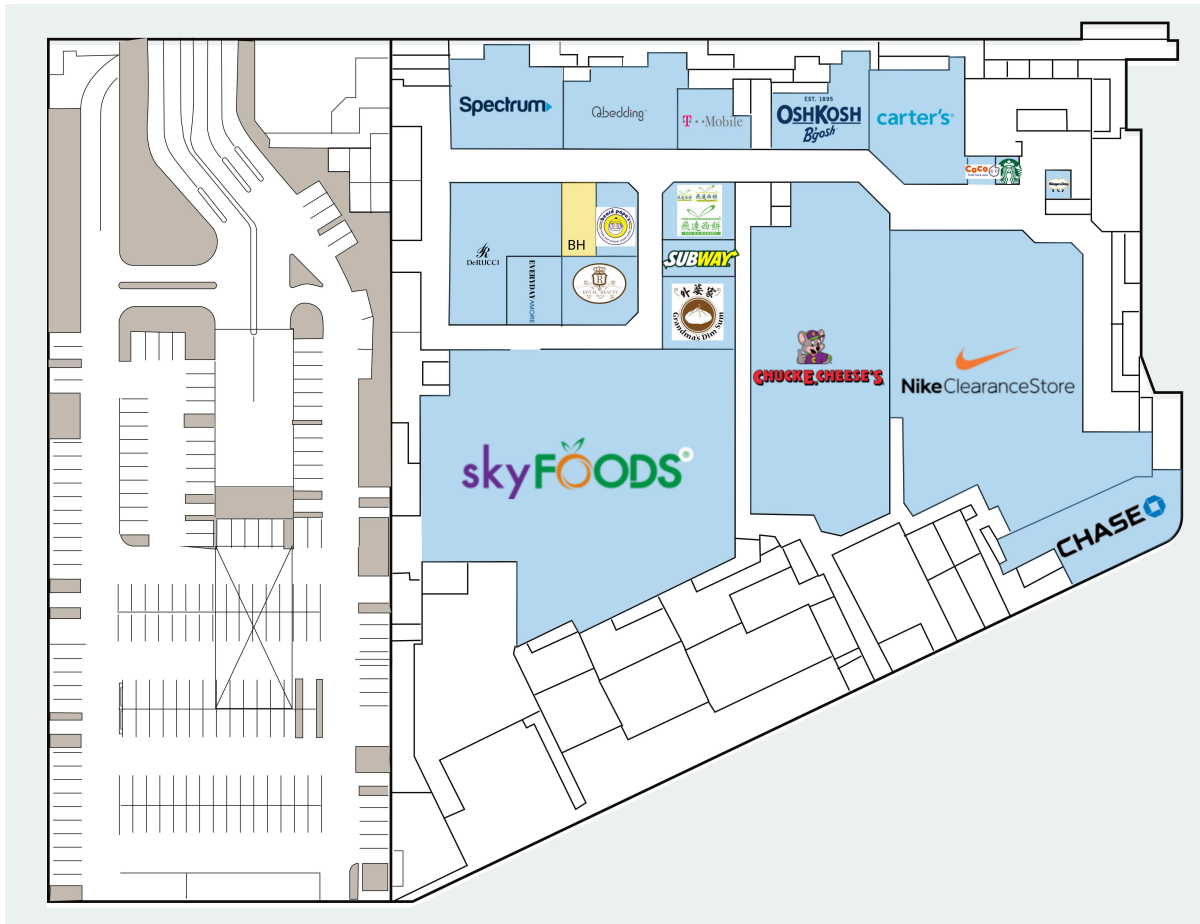

Suite	Tenant	GLA (SF)
BH	AVAILABLE	968
D02CS	AVAILABLE	400
B02B	SKY FOODS	33,592
B01E1A	NIKE CLEARANCE STORE	21,916
B01A	CHUCK E. CHEESE	17,685
BC	DERUCCI FURNITURE	4,821
B01B	CHASE BANK	4,539
BA	SPECTRUM	4,314
B04A3	CARTER'S	3,957
BB	QBEDDING	3,799
B04A2	OSHKOSH	3,090
B02A8	ROYAL QUEEN	2,094
BO	GRANDMA'S DIM SUM	2,062
B02A5	FAY DA BAKERY	1,649
B02A7	EVERYDAY BEAUTY	1,602
B02A4	T-MOBILE	1,500
B02AY	BEARD PAPA'S & GONG CHA	1,200
B02AX	SUBWAY	1,050
D02A1	BATH & BODY WORKS	500
B01E5	COCO TEA	312
K1	STARBUCKS	258
K7	HAAGEN DAZS	235

THE SHOPS AT SKYVIEW

40-24 COLLEGE POINT BLVD | FLUSHING, NY 11354



East Building - Level 4



Suite	Tenant	GLA (SF)
D02CS	AVAILABLE	400
D04A	MARSHALLS	44,734
D01A	BURLINGTON	32,530
D02A	OLD NAVY	16,260
DA	UNIQLO	11,954
DI	FOOT LOCKER	11,089
D03E	ADIDAS	9,764
D04B	FAMOUS FOOTWEAR	7,287
D02B	SEPHORA	5,000
D04C	DAISO	4,108
D03D	CONVERSE	3,790
D02C	BATH & BODY WORKS	3,029
D02A1	BATH & BODY WORKS	500

THE SHOPS AT SKYVIEW

40-24 COLLEGE POINT BLVD | FLUSHING, NY 11354



East Building - Level 6



Suite	Tenant	GLA (SF)
D02CS	AVAILABLE	400
0001	TARGET	177,462
F01	Jongro Korean BBQ	23,946
D02A1	BATH & BODY WORKS	500

THE SHOPS AT SKYVIEW

40-24 COLLEGE POINT BLVD | FLUSHING, NY 11354



West Building - Levels 1 / 3 / 5

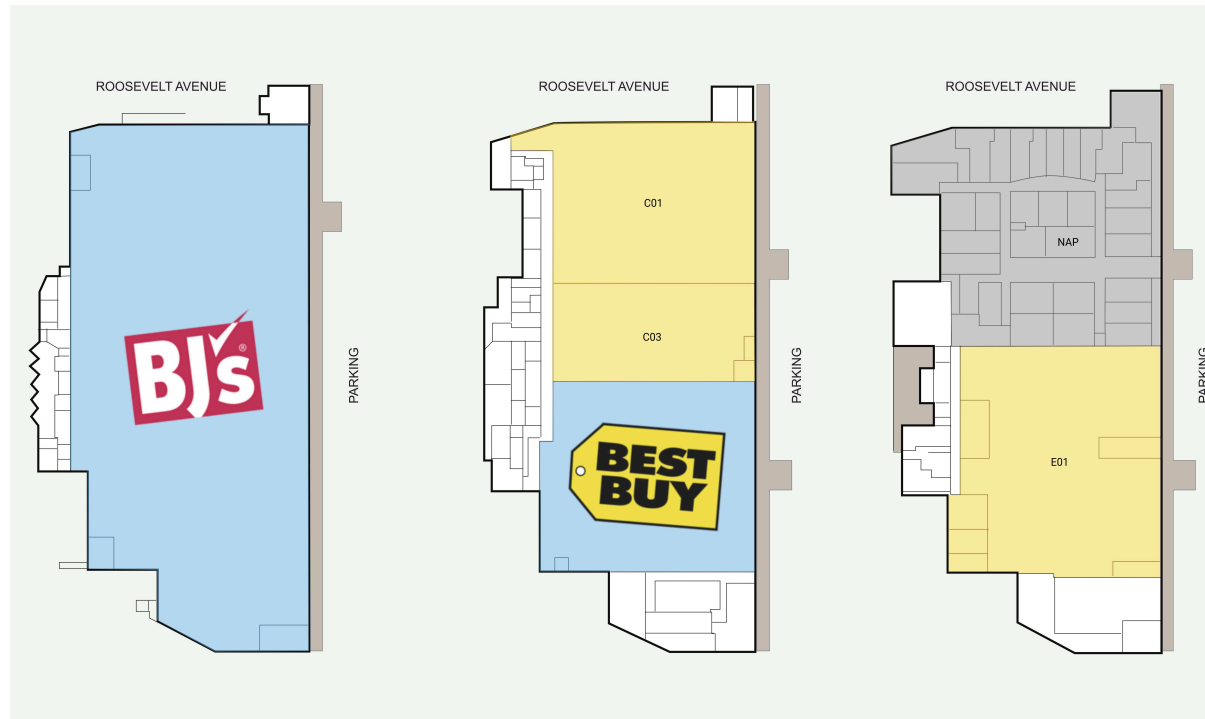

Suite	Tenant	GLA (SF)
E01	AVAILABLE	50,741
C01	AVAILABLE	35,149
C03	AVAILABLE	20,747
D02CS	AVAILABLE	400
A01	BJ'S WHOLESALE CLUB	120,860
C02	BEST BUY	45,000
D02A1	BATH & BODY WORKS	500

THE SHOPS AT SKYVIEW

40-24 COLLEGE POINT BLVD | FLUSHING, NY 11354



Get in Touch with Us

Leasing

Brian McAluney
215.330.4217
bmcAluney@shopcore.com

Pop-up & Short-term Leasing

MyShop by ShopCore
312.798.5210
myshop@shopcore.com

Property Management

Ryan Fitzgerald
718.509.1344
rfitzgerald@shopcore.com



This document is for general information purposes only. Any and all features, matters and other information depicted hereon or contained herein are for illustrative marketing purposes only, are subject to modification without notice, are not intended to be relied upon by any party and are not intended to constitute representations or warranties as to any matter, including ownership of the real property depicted hereon or any part thereof, the size and nature of improvements (or that any improvements will be constructed or will continue to exist as depicted), or the identity or nature of any occupants thereof.

Learn more about The Shops At Skyview at shopcore.com/property/the-shops-at-skyview

