

# POLO GROUNDS MALL

926 S. MILITARY TRAIL | WEST PALM BEACH, FL 33415



## Property Details

### Owned GLA

130,285 SF

### Availability

2 Suites | 3,916 SF

### Parking Spaces

601

### Overview

- Anchored by Publix with several national and regional tenant brands
- Combined traffic counts of 55,000+ VPD
- Palm Beach International Airport (PBI) is located 4 miles northeast & serves 6.7+ million passengers annually
- Located adjacent to Trump International Golf Course

## Tenant Mix

Publix.

bealls  
OUTLET.

CMLA MEDICAL CENTER  
CENTRO MEDICO LATINOAMERICANO



CHASE

UNITED STATES  
POSTAL SERVICE



# POLO GROUNDS MALL

926 S. MILITARY TRAIL | WEST PALM BEACH, FL 33415



## Demographics

Source: Creditintell, 2024.

	Population	Daytime Population	Households	Avg. HH Income	Med. HH Income
1 MILE	23,286	15,939	7,437	\$61,622	\$52,240
3 MILES	140,092	114,347	49,061	\$72,072	\$57,731
5 MILES	332,823	324,453	127,697	\$81,254	\$60,654





# POLO GROUNDS MALL

926 S. MILITARY TRAIL | WEST PALM BEACH, FL 33415



## Market Aerial

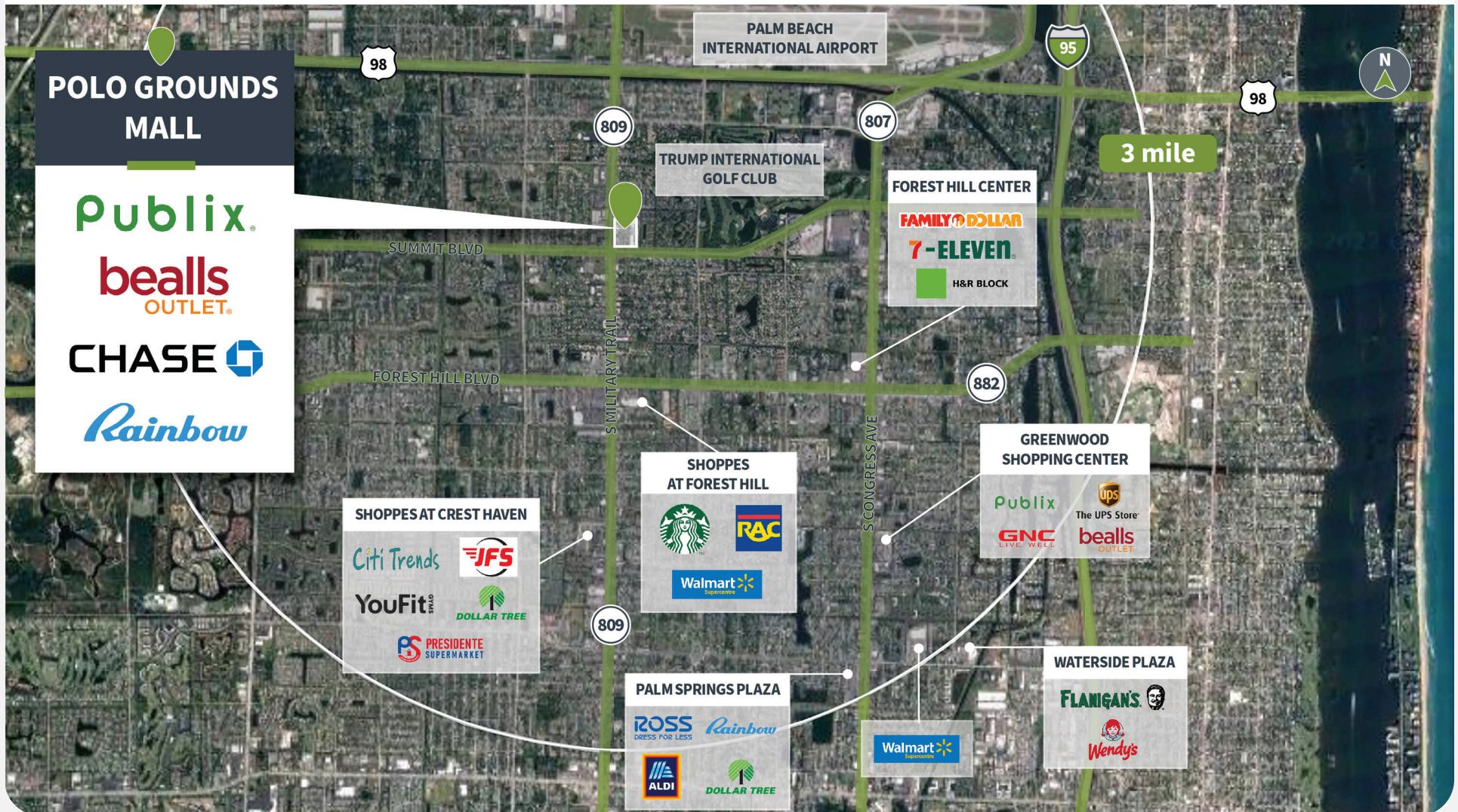

# POLO GROUNDS MALL

926 S. MILITARY TRAIL | WEST PALM BEACH, FL 33415



## Site Plan

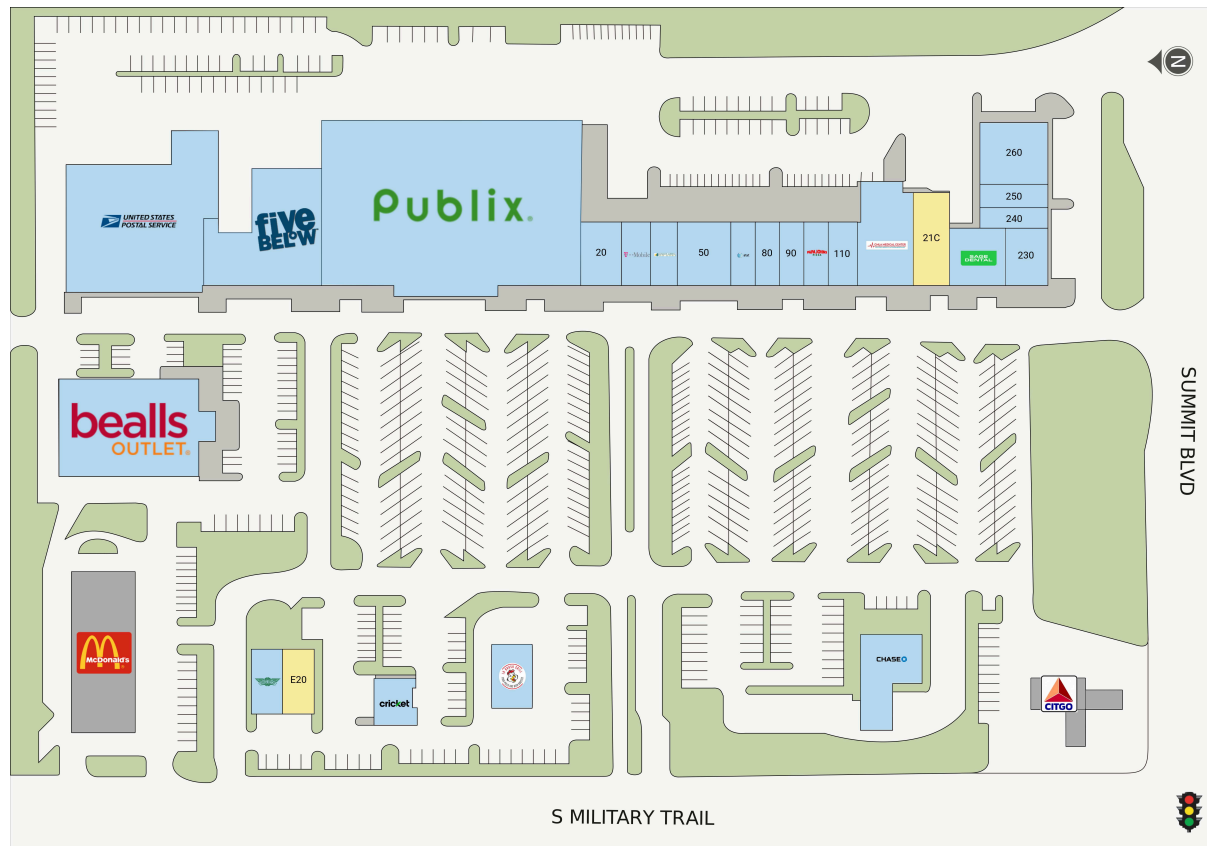

Suite	Tenant	GLA (SF)
21C	AVAILABLE	2,444
E20	AVAILABLE	1,472
10	PUBLIX SUPER MARKET	45,600
180	UNITED STATES POSTAL SERVICE	20,156
F00	BEALL'S	13,750
160	FIVE BELOW	8,930
200	CMLA MEDICAL CENTER	5,216
260	POLO GROUNDS LAUNDRY	4,000
50	STAR LIQUORS	3,500
22A	Sage Dental	2,595
C00	La Brasa	2,261
B00	CHASE BANK	2,250
230	Golden Krust	2,065
20	DIVA NAILS	1,803
110	LUSH MEDSPA	1,540
E10	WING STOP	1,504
100	PAPA JOHN'S PIZZA	1,400
90	China Queen	1,400
80	Mercedes Jewelry	1,400
70	AT&T	1,400
40	ADVANCE AMERICA	1,400
30	T-MOBILE	1,400
D00	CRICKET WIRELESS	1,280
250	XENIA SALON	1,000
240	BILL'S BARBERSHOP	1,000



# POLO GROUNDS MALL

926 S. MILITARY TRAIL | WEST PALM BEACH, FL 33415



## Get in Touch with Us

### Leasing

Sarah Jordan

**561.462.8486**

**[sjordan@shopcore.com](mailto:sjordan@shopcore.com)**

### Pop-up & Short-term Leasing

MyShop by ShopCore

**561.823.6129**

**[myshop@shopcore.com](mailto:myshop@shopcore.com)**

### Property Management

Gayle Morley

**561.727.2640**

**[gmorley@shopcore.com](mailto:gmorley@shopcore.com)**



*This document is for general information purposes only. Any and all features, matters and other information depicted hereon or contained herein are for illustrative marketing purposes only, are subject to modification without notice, are not intended to be relied upon by any party and are not intended to constitute representations or warranties as to any matter, including ownership of the real property depicted hereon or any part thereof, the size and nature of improvements (or that any improvements will be constructed or will continue to exist as depicted), or the identity or nature of any occupants thereof.*

Learn more about Polo Grounds Mall at [shopcore.com/property/polo-grounds-mall](https://shopcore.com/property/polo-grounds-mall)