

# 1001 ROSS AVENUE

1001 ROSS AVENUE // DALLAS, TX, 75202

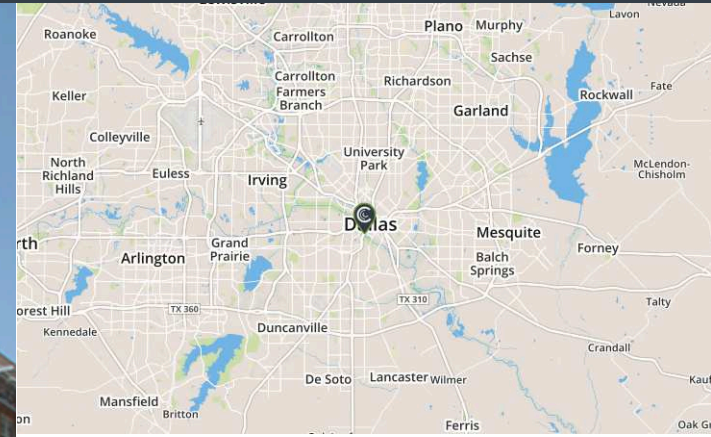

# CVS

pharmacy®

**OWNED GLA**  
30,202 SF

**LOCATION**  
Longitude: -96.805000  
Latitude: 32.782600

<b>DEMOGRAPHICS</b>	<b>1 MILE</b>	<b>3 MILE</b>	<b>5 MILE</b>
Population	27,479	181,144	391,126
Avg Income	\$147,042	\$101,138	\$104,737

- + Located in the West End area of downtown Dallas, this mixed-use development offers 30,289 square-feet of prime pedestrian retail space
- + Excellent visibility from both Ross Ave and Lamar St, and is located adjacent to the Dallas World Aquarium
- + Three minutes from the West End DART Station with access to the Blue, Green, and Orange Lines

 **SHOPCORE**  
PROPERTIES

FOR LEASING INFORMATION  
Paul Sheppard  
972-535-0435  
psheppard@shopcore.com  
www.ShopCore.com

# 1001 ROSS AVENUE

1001 ROSS AVENUE // DALLAS, TX, 75202

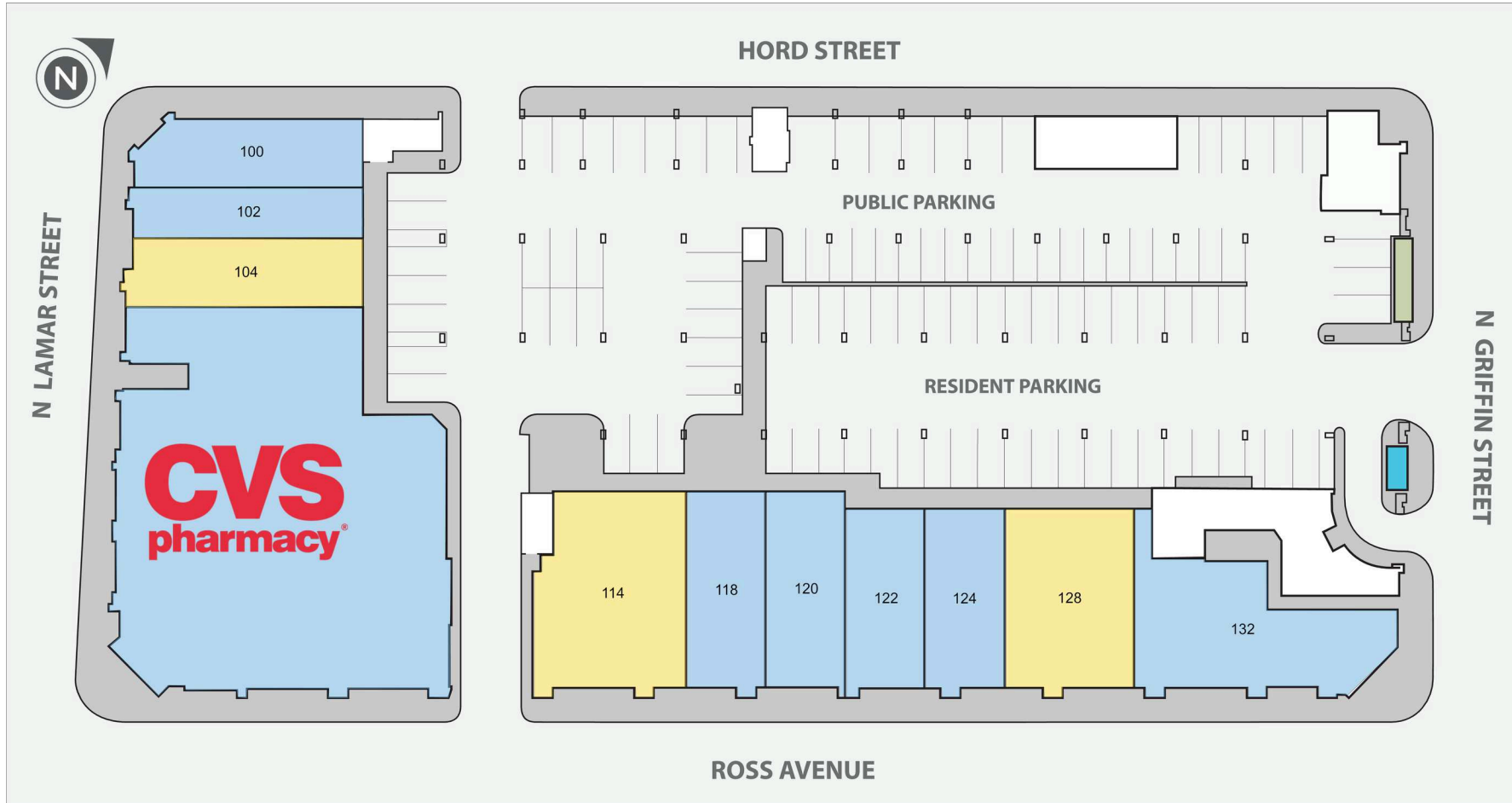

SUITE#	Tenant Name	GLA(SF)	SUITE#	Tenant Name	GLA(SF)	SUITE#	Tenant Name	GLA(SF)	SUITE#	Tenant Name	GLA(SF)
100	TEXAS TACO FACTORY	1,554 SF	112	CVS	11,463 SF	120	TIFF'S TREATS	1,589 SF	128	AVAILABLE	2,362 SF
102	AVERY'S SAVORY POPCORN	1,178 SF	114	AVAILABLE	3,000 SF	122	I FRATELLI PIZZA	1,462 SF	132	SHIVAS BAR & GRILL	2,842 SF
104	AVAILABLE	1,607 SF	118	THE EMPANADA COOKHOUSE	1,668 SF	124	BIGGER BETTER HAIR	1,478 SF			

This document is for general information purposes only. Any and all features, matters and other information depicted hereon or contained herein are for illustrative marketing purposes only, are subject to modification without notice, are not intended to be relied upon by any party and are not intended to constitute representations or warranties as to any matter, including ownership of the real property depicted hereon, the size and nature of improvements (or that any improvements will be constructed or will continue to exist as depicted), or the identity or nature of any occupants thereof.



FOR LEASING INFORMATION  
 Paul Sheppard  
 972-535-0435  
 psheppard@shopcore.com  
 www.ShopCore.com